

# STADIUM LANDING

SWC of E Katella and E Howell Ave., Anaheim, CA 92806

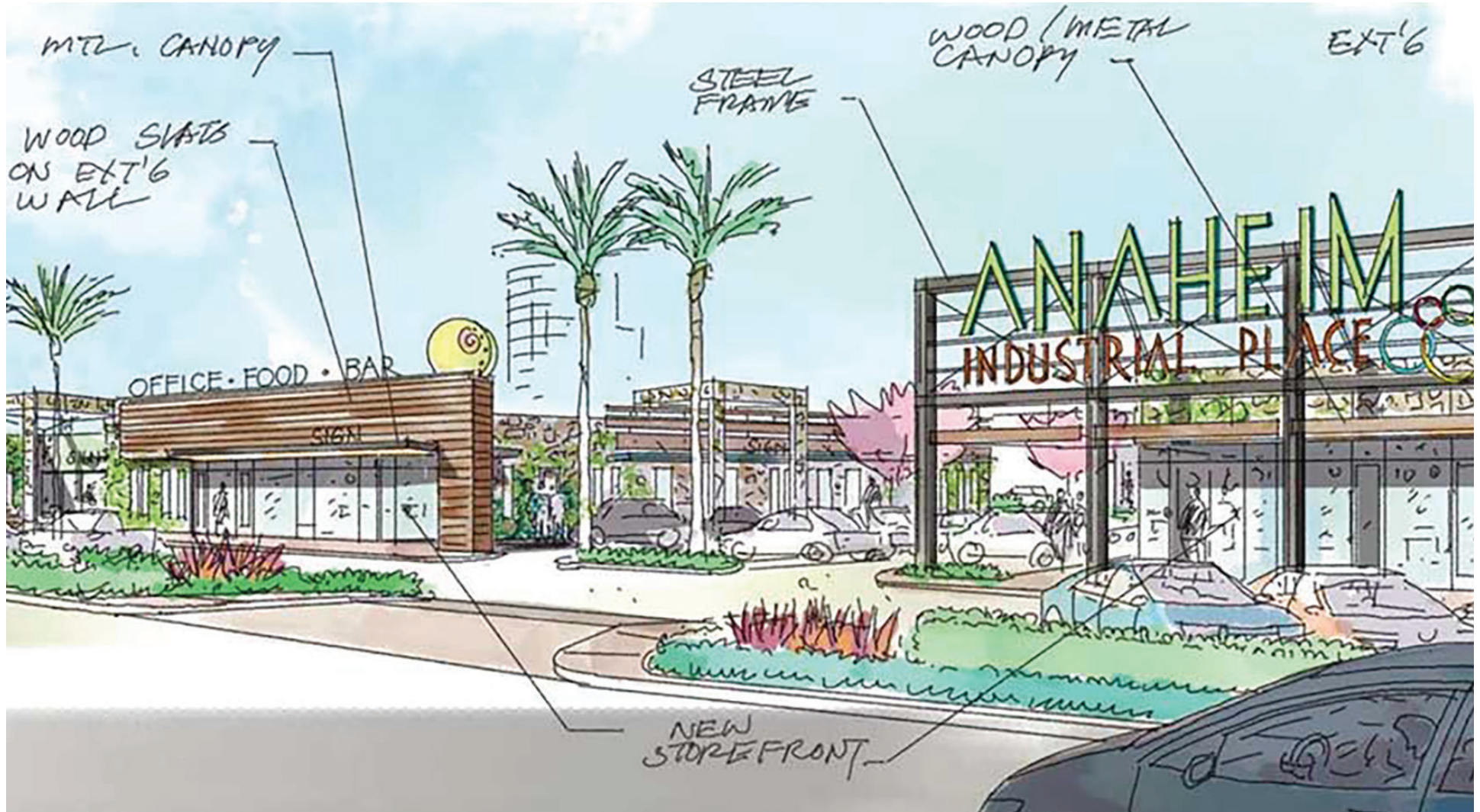

Located in Anaheim's "Platinum Triangle," Stadium Landing is directly adjacent to the 45,050 person capacity Angel Stadium (Home of the Los Angeles Angels), steps from Anaheim Regional Transportation Intermodal Center (ARTIC), and minutes from the 18,336 person capacity Honda Center (Home of the Anaheim Ducks). Phase 1 of Stadium Landing is a proposed 9.15 acre retail development that will service an already extremely popular area. Phase 2 is 8.13 acres intended for Industrial Reuse. We see an excellent opportunity to service not only attendees of these surrounding event locales, but local businesses and residents as well.



# STADIUM LANDING

← Disneyland (approx. 2 miles from Stadium Marketplace)



## TYPE:

**Phase 1:** Retail/Restaurant/  
Community Services

**Phase 2:** Industrial Reuse

## SIZE:

**Phase 1:** 9.15 Acres

**Phase 2:** 8.13 Acres

## HIGHLIGHTS

- Directly adjacent to Angel Stadium of Anaheim which hosts professional baseball as well as college football games, National Football League pre-season games, concerts and other events including AMA Supercross Championship races.
- Minutes from ARTIC which services Metrolink Orange County Line and Amtrak Pacific Surfliner and provides access to the stadium, and Disneyland.
- Directly across Hwy 57 from the Honda Center
- Approximately 2 miles from Disneyland
- Satisfies a strong need for smaller, necessity-based shopping opportunities